

AMKG

Ηλεκτροσύνδεσμος PE - PVC/PP

for joining PVC / PP pipes and HD-PE pipes SDR 33 – SDR 17

Smooth material transition of HD-PE pipes (SDR 33 – SDR 17) to PVC/PP pipes in house service connections. HD-PE end with integrated coupler. PVC/PP end as slip-on coupler with SBR lip seal and a large insertion depth.

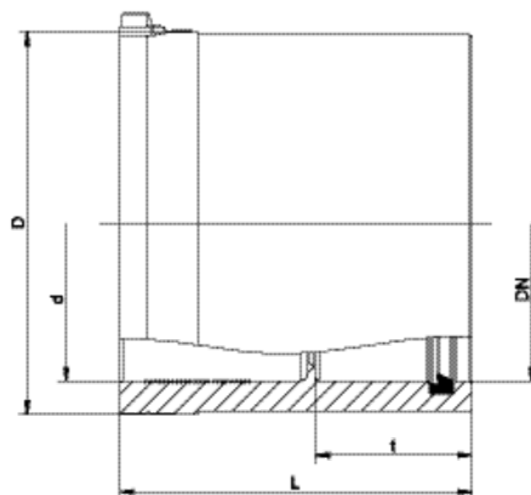



Ηλεκτροσύνδεσμος PE – PVC/PP

Sewage pipe systems are high-value assets of a value which has to be maintained for a long time. Increasing demands on the public sewage system require materials which meet these criteria. HD-PE sewage pipes have been fused for many years with the FRIAFIT HD-PE sewage system tightly, frictionlocked and root-proof.

AREAS OF APPLICATIONS

The FRIAFIT transition coupler AMKG serves as seamless material transition of pipes made of HDPE (wall thicknesses of SDR 33 to SDR 17) to pipes made of PVC/PP in house service applications.

NOTES ON PROCESSING

The HD-PE end with integrated coupler is connected by FRIAFIT electrofusion – leak-tight and frictionlocked.

The pipe ends are prepared according to the general installation requirements (see "Installation instructions" for the FRIAFIT sewage system) (remove oxide layer/ clean).

A PVC/PP pipe is inserted at the slip-on coupler end. The slip-on coupler has a SBR lip seal and a large insertion depth for a secure guiding of the pipe.

GOOD REASONS FOR THE FRIAFIT TRANSITION COUPLER AMKG:

Integrated fusion coupler end

Guarantees leak-tight, friction-locked and rootproof connection

Seamless material transition when using HD-PE pipe SDR 33–SDR 17, no protrusion in the joining area, no constriction of drainage

Reduction of the installation time thanks to integrated fusion coupler

Large coupler depth for good guiding of the pipe (no fixing devices required)

Exposed, fixed heating coil for direct heat transfer to the pipe

Barcode for fully automatic fusion with HD-PE pipes from SDR 33 to SDR 17, taking into consideration the ambient temperature (temperature compensation)

Slip-on coupler end

Guiding of the PVC / PP pipe thanks to a large insertion depth

SBR lip seal according to EN 681-1

Standardised material transition