

VMDF – Βάνα Διαφράγματος

Diaphragm valve with male ends for socket welding, metric series

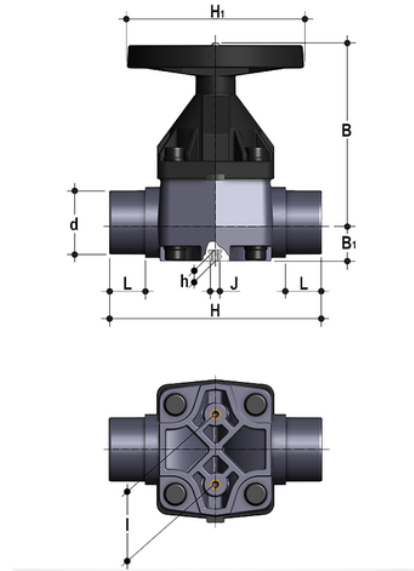

EPDM

| Κωδικός προϊόντος | tooltiplimage | d | DN | PN | B | B[5:1] | H | H[5:1] | h | l | J | L | g |
|-------------------|---------------|-----|-----|-----|-----|--------|-----|--------|----|-----|-----|----|-------|
| VMDF090E | - | 90 | 80 | *10 | 225 | 55 | 300 | 200 | 23 | 100 | M12 | 51 | 7840 |
| VMDF110E | - | 110 | 100 | *10 | 295 | 69 | 340 | 250 | 23 | 120 | M12 | 61 | 11670 |

FKM

| Κωδικός προϊόντος | tooltiplimage | d | DN | PN | B | B[5:1] | H | H[5:1] | h | l | J | L | g |
|-------------------|---------------|-----|-----|-----|-----|--------|-----|--------|----|-----|-----|----|-------|
| VMDF090F | - | 90 | 80 | *10 | 225 | 55 | 300 | 200 | 23 | 100 | M12 | 51 | 7840 |
| VMDF110F | - | 110 | 100 | *10 | 295 | 69 | 340 | 250 | 23 | 120 | M12 | 61 | 11670 |

PTFE

| Κωδικός προϊόντος | tooltiplimage | d | DN | PN | B | B[5:1] | H | H[5:1] | h | l | J | L | g |
|-------------------|---------------|-----|-----|-----|-----|--------|-----|--------|----|-----|-----|----|-------|
| VMDF090P | - | 90 | 80 | *10 | 225 | 55 | 300 | 200 | 23 | 100 | M12 | 51 | 7840 |
| VMDF110P | - | 110 | 100 | *10 | 295 | 69 | 340 | 250 | 23 | 120 | M12 | 61 | 11670 |

VMDF – Βάνα Διαφράγματος

- **Handwheel** in (PA-GR) with high mechanical strength and ergonomic **grip for optimum manageability**
- **Metal optical position indicator** supplied as standard
- **Full protection bonnet in PP-GR** Internal circular and symmetrical diaphragm sealing area
- Diaphragm available in EPDM, FPM, PTFE (NBR on request) and easy to replace
- **Threaded metal inserts** for anchoring the valve
- **New valve body internal design:** substantially higher flow coefficient resulting in lower pressure drops. Optimised adjustment curve for effective and precise flow rate regulation
- Connection system for solvent welding and for flanged joints
- **Optimised fluid dynamic design:** maximum output flow rate thanks to the optimised efficiency of the fluid dynamics that characterise the new internal geometry of the body
- Handwheel that stays at the same height during rotation, with internal bearing to minimise friction and operating torque
- Standard optical indicator
- **Internal operating components in metal** totally isolated from the conveyed fluid
- Bonnet fastening screws in STAINLESS steel protected against the external environment by PE plugs
- **New flanged bodies:** the new bodies, characterised by a monolithic flanged structure, are available in PVC-U, PVC-C, PP-H and PVDF. This design, free from body and flange joints, greatly reduces mechanical stress and increases system performance.