

MB SDR 11

Coupler with easily removable inner stop, SDR 11

Coupler MB SDR 11 with inner stop

- Gas, water and H₂
- Maximum pressure: Gas 10 bar, Water 16 bar
- Material: PE 100
- Easily removable inner stop
- Safety technology
- Large insertion depth for good pipe routing (no holding devices required)
- DVGW test mark: DV-8601AU2248 and DV-8606AU2249

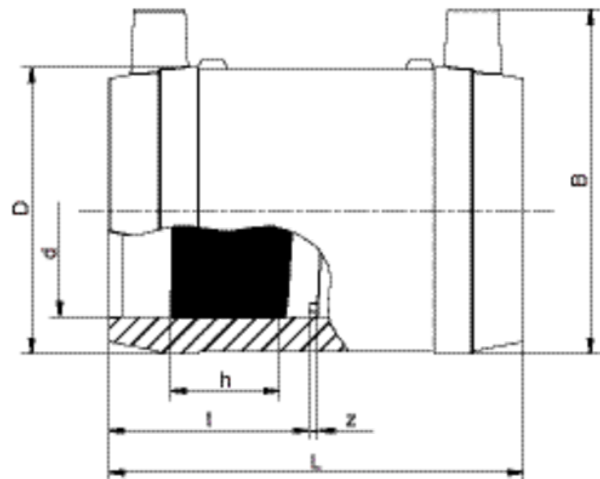

MB SDR 11

Coupler with easily removable inner stop, SDR 11

Areas of Application

The FRIALEN-coupler MB is used for pipe connections when laying long runs. Additional areas of application:

- Integration of adapters into an existing pipe-line
- Connection of pipelines with fixed or restraint points
- Reinforcement / sealing of localised pipe damage
- Reinforcement of pinch points

Assembly Instructions

The fusion of pipe ends with the FRIALEN-coupler MB takes place using FRIALEN-fusing – leakproof and longitudinally strong.

The pipe ends are prepared according to the general installation instructions (see "Assembly Instructions" for "FRIALEN-Safety Fittings for house connections and distribution pipes up to d 225"). This involves removing the oxide skin and cleaning the pipe ends. Please note that spigot of valves must be at least half as long as the coupler.

Good reasons for using the FRIALEN Coupler MB:

- Large coupler depth for ease of pipe guiding (no holding clamps required)
- Extra wide fusion zones
- Maximum stability through great wall thickness
- Cold zones at the front side and in the middle of the coupler
- Exposed heating coil for direct heat transmission to the pipe
- Small annular gap for build-up of optimum joining pressure in the fusion zone
- Touch proof electric contacts
- Fusion indicator for visual fusion control
- Durable batch marking
- Individually wrapped for dirt protection
- Additional barcode for tracing back the fitting (Traceability-Coding)