

WUN 90

90° transition elbow HD-PE/brass with external thread

Transition elbow brass pipe WUN 90

- Water
- Maximum pressure: Water 16 bar
- Material: PE 100 and brass (EN 12168 - CW617N, thread according to EN 10226-1)
- Safety technology

Note:

The brass side is anchored as non-detachable and non-rotatable in PE.

Self-sealing, patented sealing geometry without elastomeric seal for utilisation in water areas.

Default: Brass, gunmetal on request.

Other thread dimensions available on request.

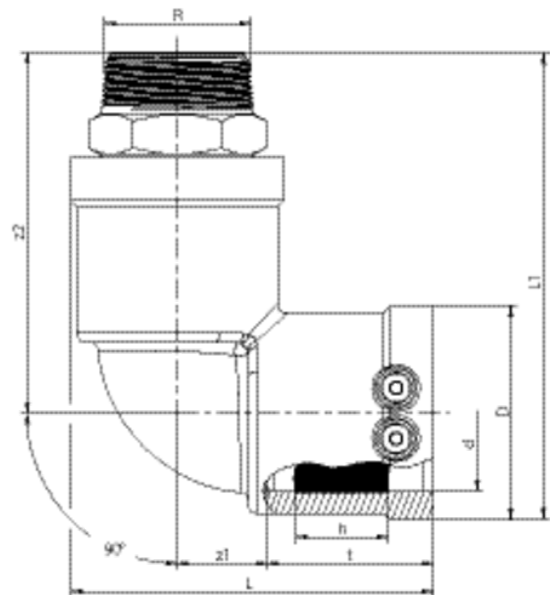

WUN 90

90° transition elbow HD-PE/brass with external thread

Areas of Application

FRIALEN-Transition Elbows WUN 90° are threaded joints as an adaptor from a metal pipe with internal thread to a HD-PE pipe. Joint on the part of HD-PE by FRIALEN-Coupler.

Assembly Instructions

The threaded component must be held with a spanner to prevent it twisting in the HD-PE component. The fusion of the HD-PE side takes place by FRIALEN-fusing – leakproof and longitudinally strong.

The installation of the brass and the HD-PE side has to be prepared according to the general installation instructions (see "Transition Fittings with threaded connection" in "Assembly Instructions" for "FRIALEN-Safety Fittings for house connections and distribution pipes up to d 225"). This involves removing the oxide skin and cleaning the pipe ends.

Good reasons for using the FRIALEN-Transition Elbows WUN 90°:

- Compact construction
- HD-PE side with exposed heating element for optimal heat transfer
- Cold zones at the end to prevent the flow of molten material
- No holding clamps required
- Large insertion depth, extra wide fusion zones
- Brass end permanently anchored in the HD-PE and will not distort
- Self sealing patented sealing geometry without elastomer seal
- Additional barcode for tracing back the underground fitting (Traceability-Coding)